

# SwallowSTRONG Device Set-Up

*\* Before use, charge the device for 8 hours (overnight).*

## Components

### 1. SwallowSTRONG Interface

The SwallowSTRONG interface features a touchscreen and a port for connecting the converter cords and charger.

---



### 2. Converter Cords

The smaller of these two cords, converter cord 2a, connects directly to the SwallowSTRONG interface and should be plugged in first. The larger cord, converter cord 2b, plugs into the 2a, and leads to the transducer box.

---

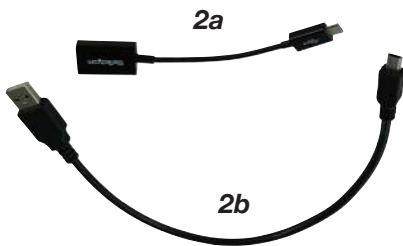

### 3. Transducer Box

The transducer box connects to converter cord 2b and the mouthpiece.

---



### 4. Mouthpiece

The mouthpiece should only be assigned to one patient. It connects to the device via the transducer box.



**Clinician**

## SwallowSTRONG Device Set-Up

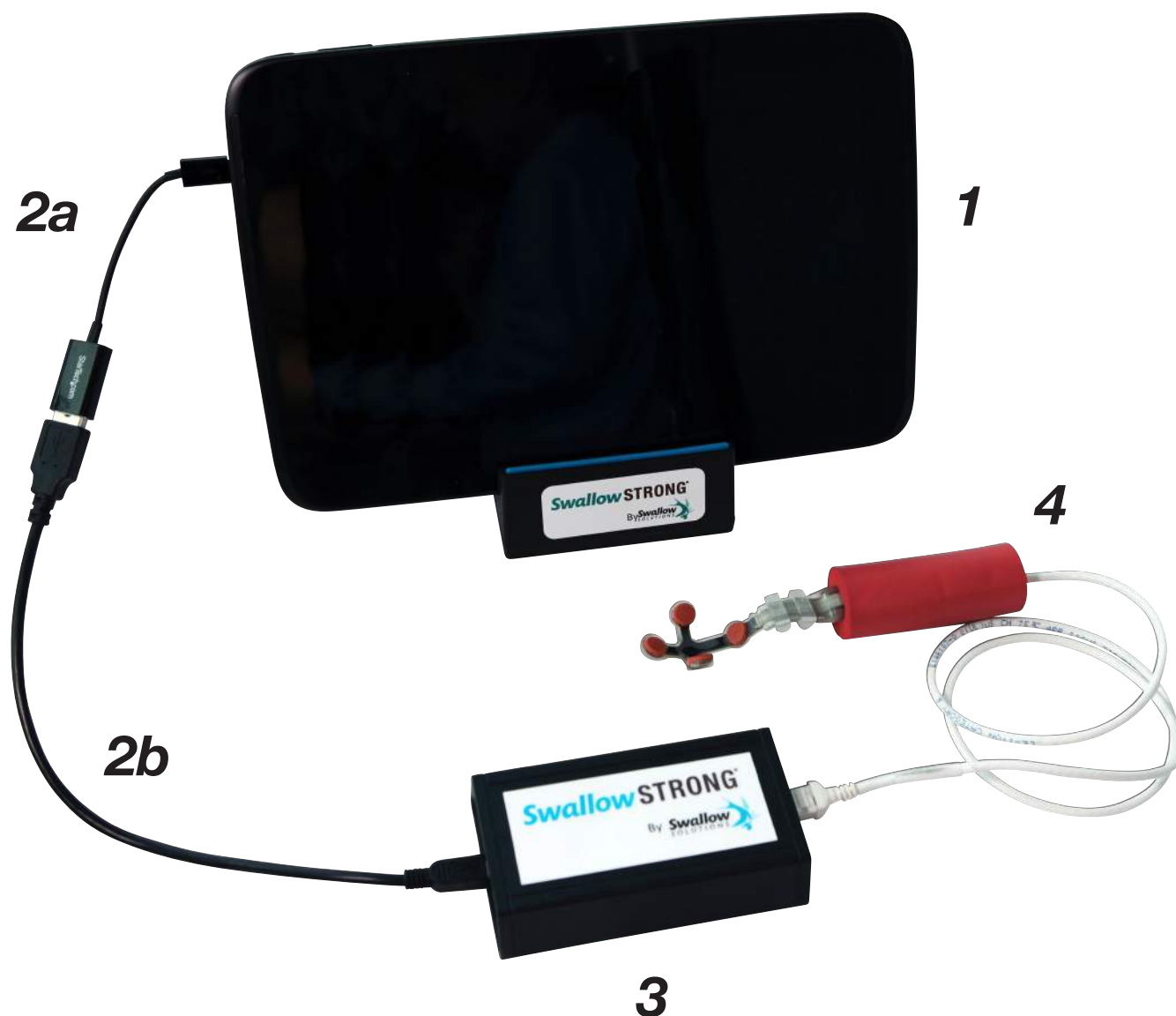

### Fully Assembled SwallowSTRONG Device

**NOTE:** The device comes with a charger (not pictured) that can only be plugged in when the mouthpiece is not in use.

## SwallowSTRONG Device Set-Up

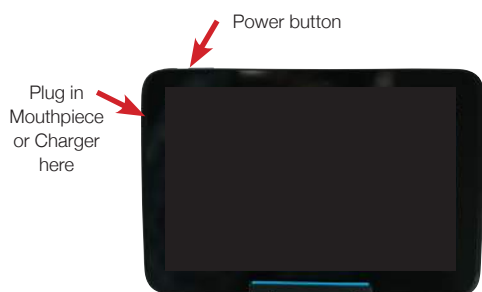

Figure 1. Orientation of the power button and port.

Swallow Solutions logo. Touch and hold to navigate to clinician home page.



Figure 2. The logo appears on every page.

5. Set the device in the stand and press the power button. See *Figure 1*.
6. Tap the **'Swallow' icon** in the upper left-hand corner of the home screen.
7. The message **'Allow the app Swallow to access the USB device'** will appear. Tap **OK**.
8. The message **'Enter Mouthpiece Information Or Plug in a Mouthpiece'** will appear. The mouthpiece serial number will automatically populate in the white box. Tap **Submit to continue**.
9. Touch and hold the **SwallowSTRONG logo** on the top left corner of the screen to get to the clinician home page. See *Figure 2*.
10. See the treatment guide for typical therapy workflow.