

SwallowSTRONG Device Set-Up

** Before use, charge the device for 8 hours (overnight).*

Components

1. SwallowSTRONG Interface

The SwallowSTRONG interface features a touchscreen and a port for connecting the converter cords and charger.



2. Converter Cords

The smaller of these two cords, converter cord 2a, connects directly to the SwallowSTRONG interface and should be plugged in first. The larger cord, converter cord 2b, plugs into the 2a, and leads to the transducer box.

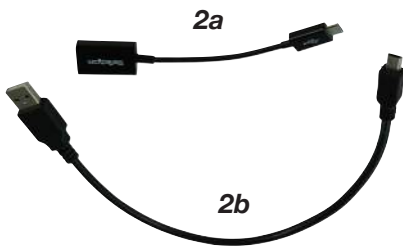

3. Transducer Box

The transducer box connects to converter cord 2b and the mouthpiece.



4. Mouthpiece

The mouthpiece should only be assigned to one patient. It connects to the device via the transducer box.



Patient

SwallowSTRONG Device Set-Up

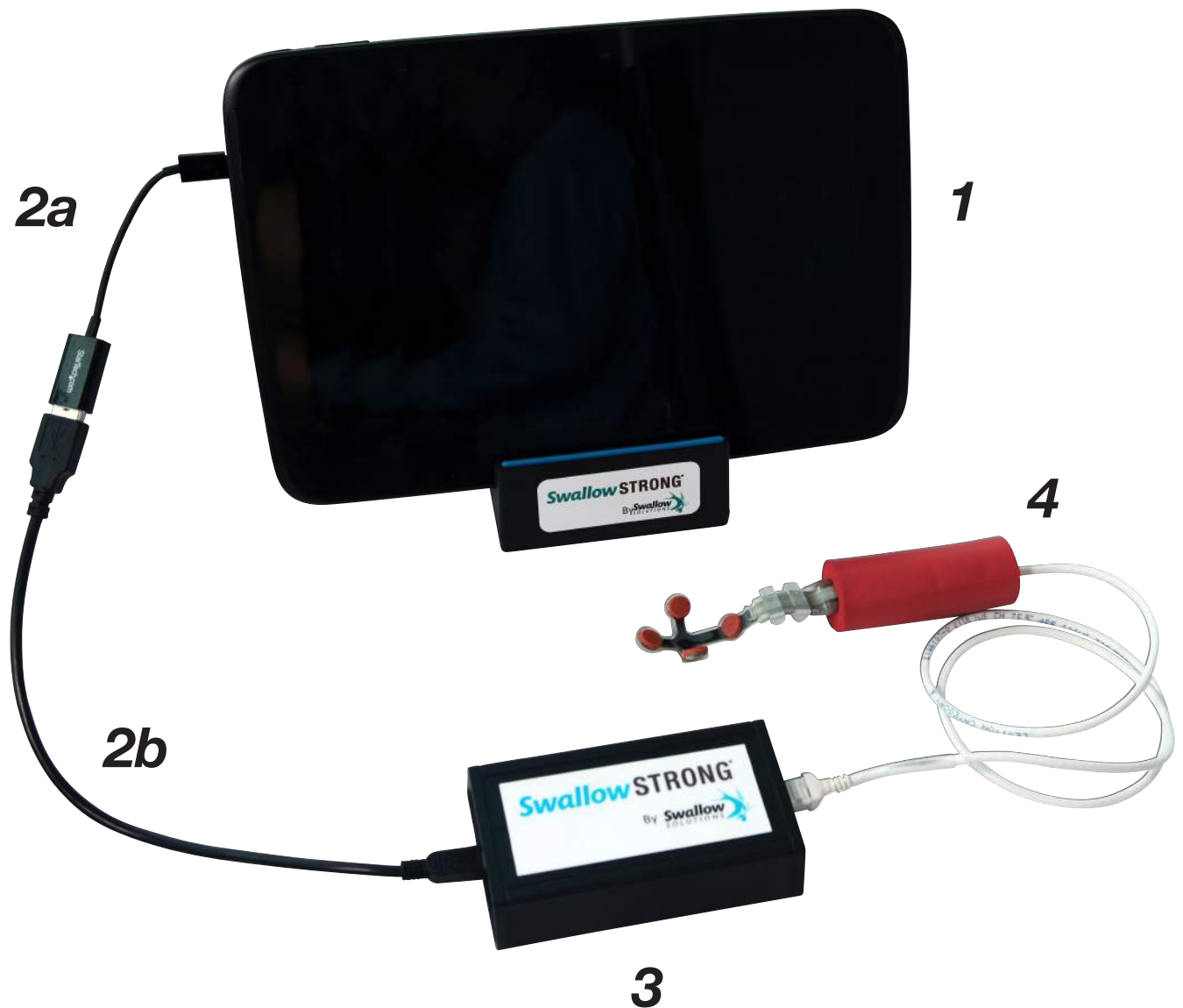

Fully Assembled SwallowSTRONG Device

NOTE: The device comes with a charger (not pictured) that can only be plugged in when the mouthpiece is not in use.